

**UNIVERSITY COLLEGE TATI (UC TATI)****FINAL EXAMINATION QUESTION BOOKLET**

COURSE CODE	: DTD 1013
COURSE	: TECHNICAL DRAWING (ACAD)
SEMESTER/SESSION	: 2-2024/2025
DURATION	: 3 HOURS

Instructions:

1. This booklet contains 5 questions. Answer ALL questions.
2. All answers should be drawn using AutoCAD software. Save your files with the name **(24A15XXXX_Q1/2/3/4/5.DWG)**. Where **24A15XXXX** is your matric number and Q is the question number.
3. Save your drawing file into the created folder **24A15XXXX_FINAL_CADLABX/BDL_WSXX** on your desktop. Where **24A15XXXX** is your matric number, **CADLAB/BDL** is the final examination venue and **WS** is your workstation number.
4. If in doubt, raise your hands and ask the invigilator.

DO NOT OPEN THIS BOOKLET UNTIL YOU ARE TOLD TO DO SO

THIS BOOKLET CONTAINS 7 PRINTED PAGES INCLUDING COVER PAGE

TECHNICAL DRAWING (DTD 1013)

Instruction:

Please ensure that all the answers to be saved together in one folder located at your workstation desktop. The folder name is: **24A15XXXX_FINAL_CADLABX/BDL_WSXX**. Save your files with name **24A15XXXX_Q1/2/3/4/5.DWG**. Please save your drawing frequently throughout this examination to avoid any issues. All measurements shown in this question paper are in millimeters (mm).

QUESTION 1

Construct Figure 1 by applying engineering principles:

- a) Object (5 marks)
- b) Dimensioning (3 marks)
- c) Layer management (3 marks)

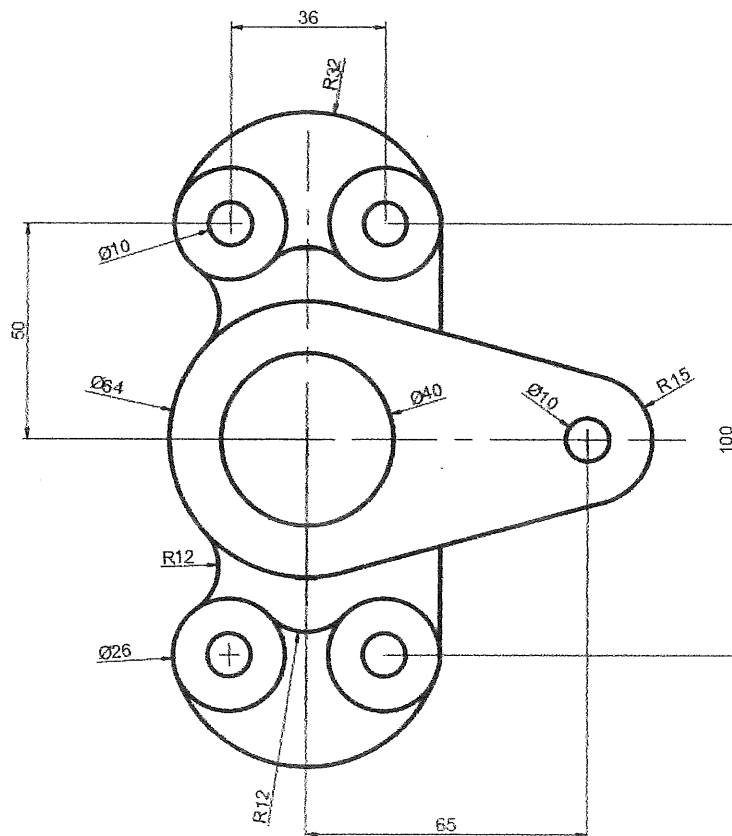

Figure 1

QUESTION 2

Construct Figure 2 by applying engineering principles:

- a) Object (5 marks)
- b) Dimensioning (3 marks)
- c) Layer management (3 marks)

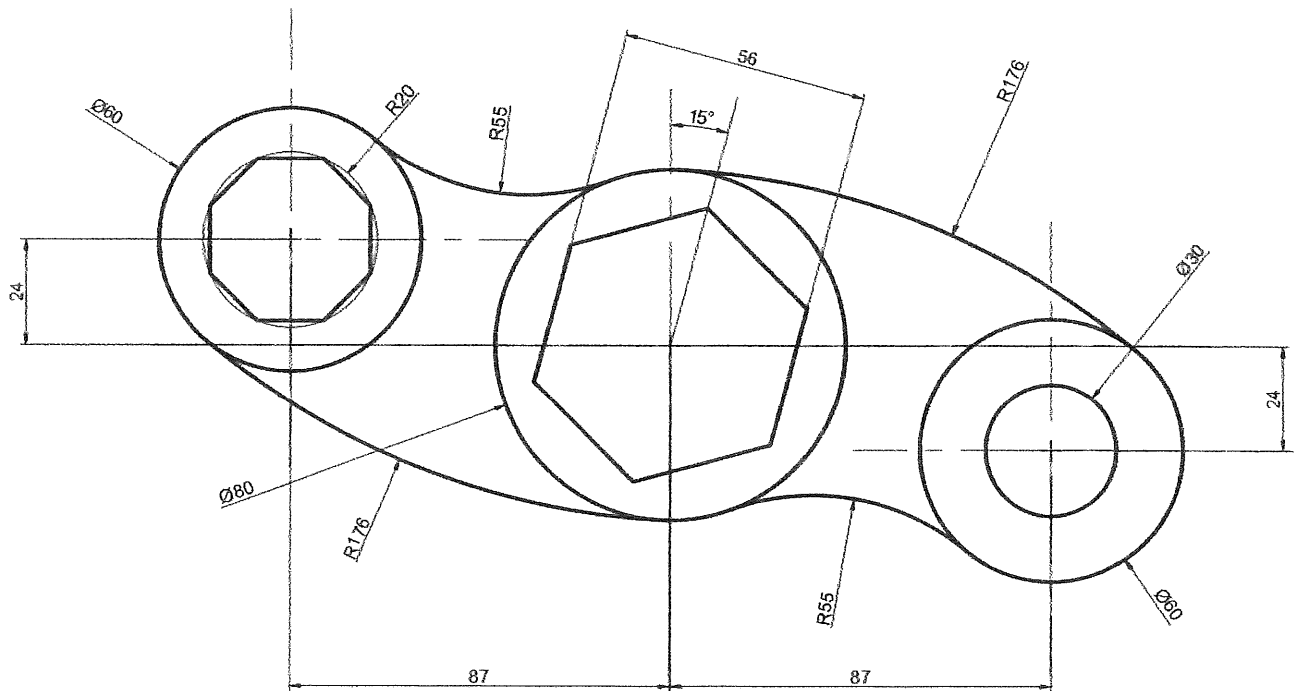

Figure 2

QUESTION 3

Figure 3 shows the isometric view of a part. **Illustrate** the orthographic drawing in full scale, employing 3rd angle projection.

- a. Front view from direction A (7 marks)
- b. Plan view (7 marks)
- c. Right side view (7 marks)
- d. Dimensioning and layer management (4 marks)

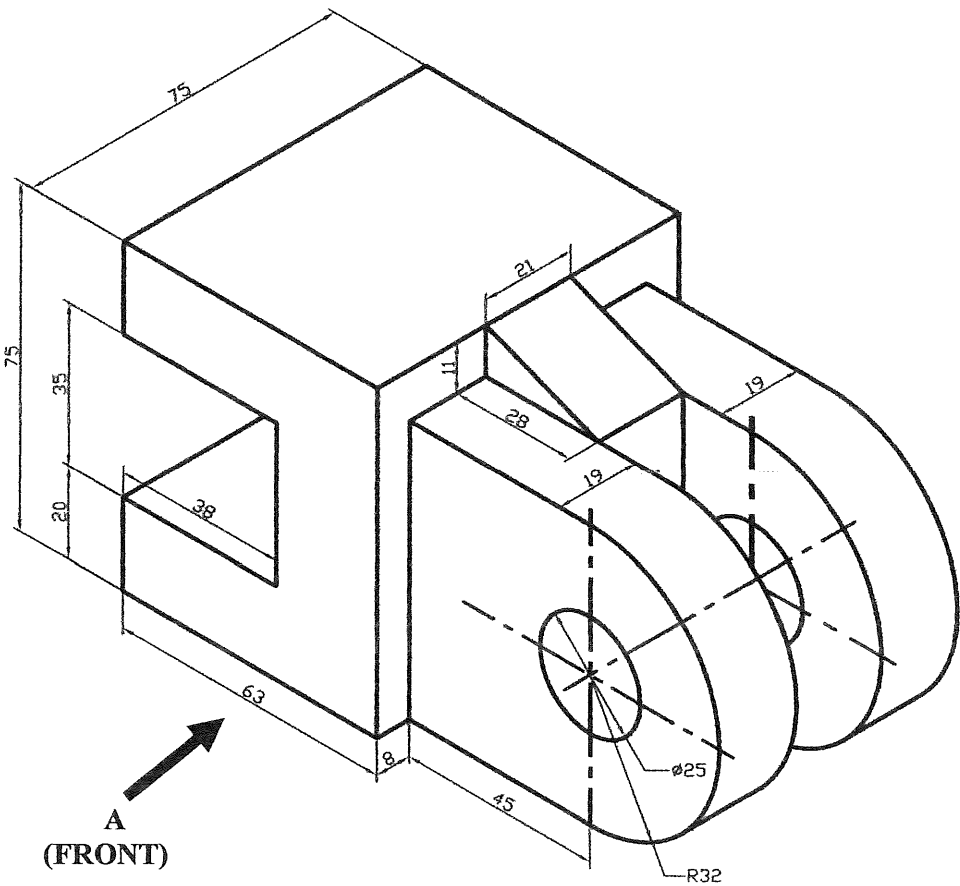

Figure 3

QUESTION 5

Figure 5 presents an isometric drawing together with a cutting plane line, while Figure 6 shows the plan and front views of the crank arm part. By using this information, **construct** a sectional view and orthographic projection using 1st angle projection method .

- a. Front sectional view from X-X (10 marks)
- b. Plan view with cutting plane line (10 marks)
- c. Right side view (6 marks)
- d. Dimensioning (3 marks)
- e. Layer management (5 marks)

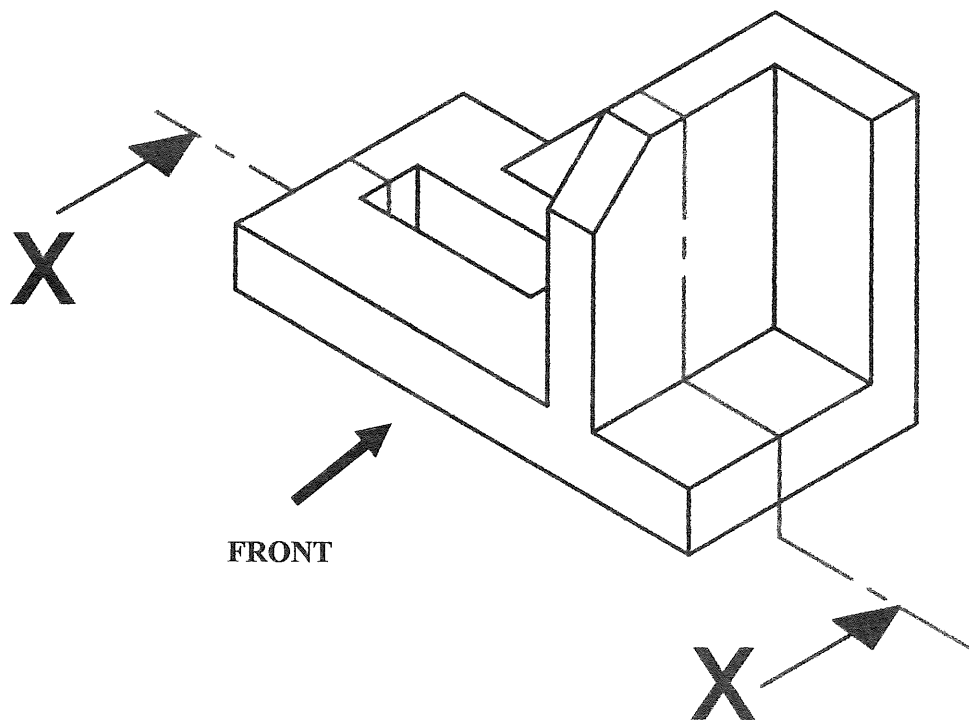

Figure 5